

PARTS LIST

ITEM	QTY	PART NUMBER	DESCRIPTION
1	1	-	Customer Supplied Ceramic Board
2	4	M2x0.4 x 3	Mo, Slotted Pan Head Machine Screw
4	1	107935	Ø1/2 O2 Heater Assembly w/TC

This document is the property of HeatWave Labs. Its contents may not be reproduced without express written permission of HeatWave Labs.

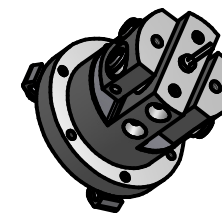
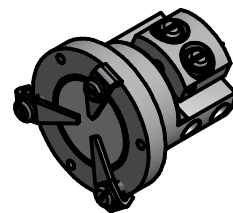

B

B

Ceramic Insulator 2X SST Heater Contact

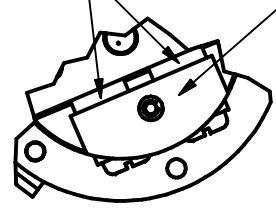
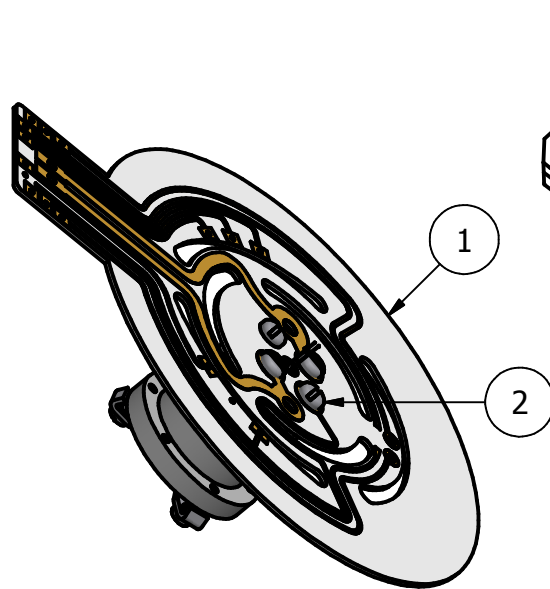

DETAIL A
SCALE 2 : 1

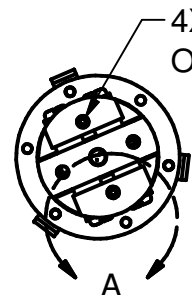

4X M2x0.4 ∇ .100
On Ø.400 BHC @ 90°

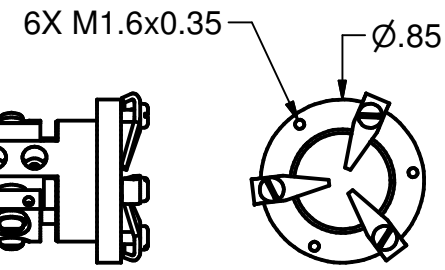
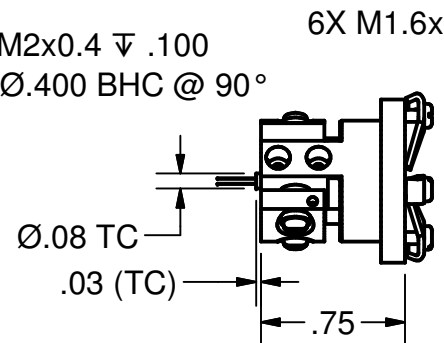

Notes:

1. All parts must be clean for UHV use prior to assembly per MP-264.
2. Assembly must be handled with good clean room practice per MP-220.
3. Estimated operation:
9.6V, 3.6A @ 1000°C
12.7V, 3.9A @ 1200°C
4. The materials exposed to the chamber atmosphere are SST 310, Inconel 600, Ti, Alumel, Chromel, Alumina and Pt/Rh. All fasteners on the heater assembly will be Ti. The screws supplied to mount the heater assembly to the board are Moly.

A

A

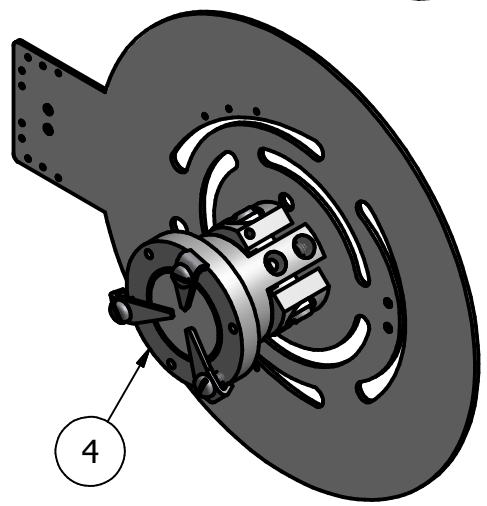

DRAWN mcurtis	9/4/2012
CHECKED	
QA	
MFG	
APPROVED	
Material:	

HeatWave Labs, Inc. 195 Aviation Way, Suite 100 P: 831-722-9081
Watsonville, CA 95076 F: 831-722-5491
www.cathode.com

Board Mounted Ø1/2 O2 Heater Assembly w/Sample Clips

SIZE A	Cage Code: 1YAN4	DWG NO 107887	REV
SCALE 1x	SHEET 1 OF 2		

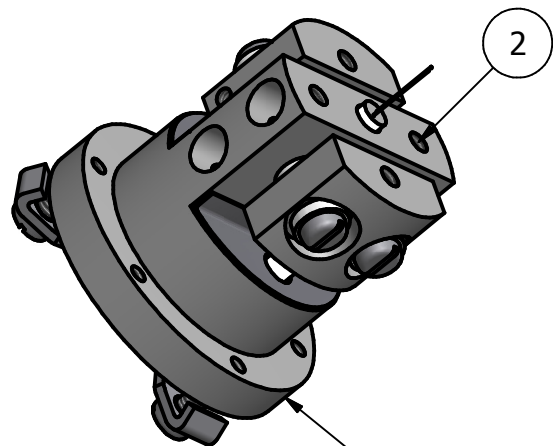

Heater & TC Screws
M2x0.4 x 3mm
Ti Slotted Set Screw

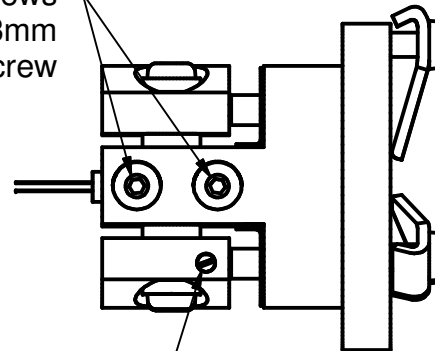

2X Filament Set Screw Location

3X M1.6x0.35 x 6mm
Ti Slotted Set Screw

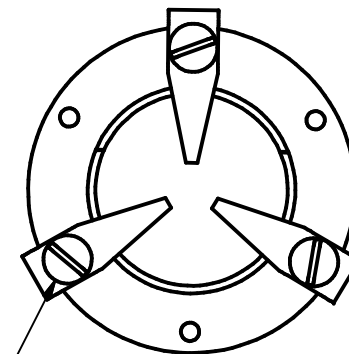

B

B

Board Mounting Instructions:

1. Loosen the two set screws (5), one for each filament lead.
2. Loosen 2X screws (4) for each pad just enough to allow pads (3) to move. These screws must not allow the pads to move more than what is required to seat flat on the board.
3. Mount housing (1) to board with screws supplied in two holes (2), secure.
4. Install one screw supplied into each pad and snug with minimal torque to seat pads to board. Care must be taken not to twist the pad in its location. If it does twist the two screws (4) are too loose.
5. Tighten two screws (4) on each pad to secure pad to housing. Minimal torque must be used to not stress the board materials.
6. Tighten one screw (5) for each filament lead to secure and make electrical contact.

M1.6x0.35 x 6mm
Ti Socket Pan Head

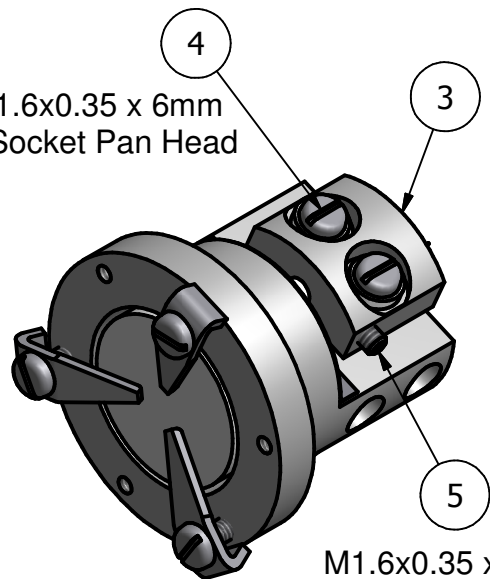

M1.6x0.35 x 3mm
Ti Slotted Set Screw

A

A

DRAWN mcurtis	9/4/2012
CHECKED	
QA	
MFG	
APPROVED	

<i>HeatWave Labs, Inc.</i>		195 Aviation Way, Suite 100 P: 831-722-9081 Watsonville, CA 95076 F: 831-722-5491 www.cathode.com	
Board Mounted Ø1/2 O2 Heater Assembly w/Sample Clips			
SIZE A	DWG NO 107887	REV	
SCALE 1x	SHEET 2 OF 2		

This document is the property of HeatWave Labs.
Its contents may not be reproduced without
express written permission of HeatWave Labs.

