

Dash # Next Assembly

- -

REVISIONS			
REV	DESCRIPTION	DATE	APPROVED
A	Design change to improve electrical insulation.	11/13/07	MC
B	Redesigned heater to have exposed filament.	7/23/08	MC
B1	Changed estimated operation numbers to reflect actual filament temps.	5/11/09	MC

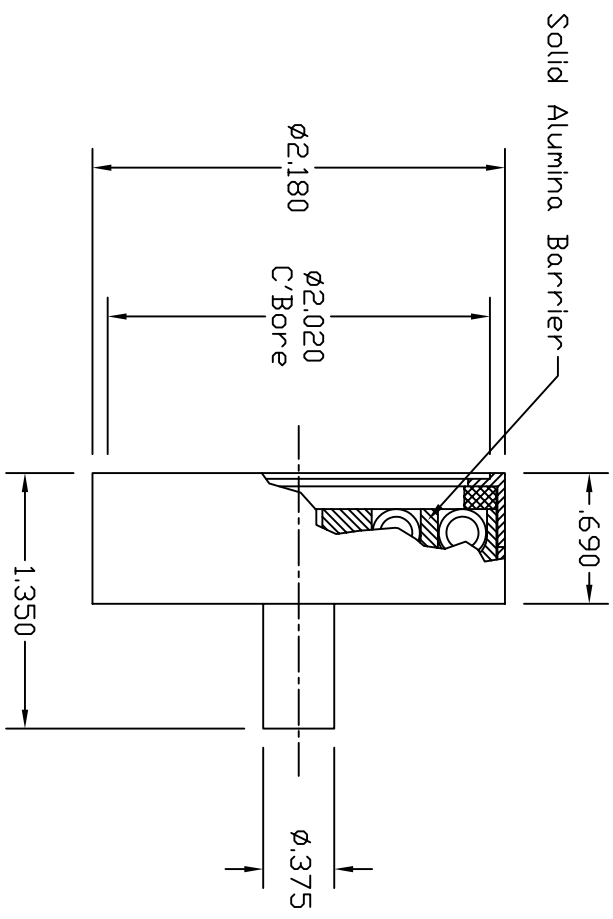
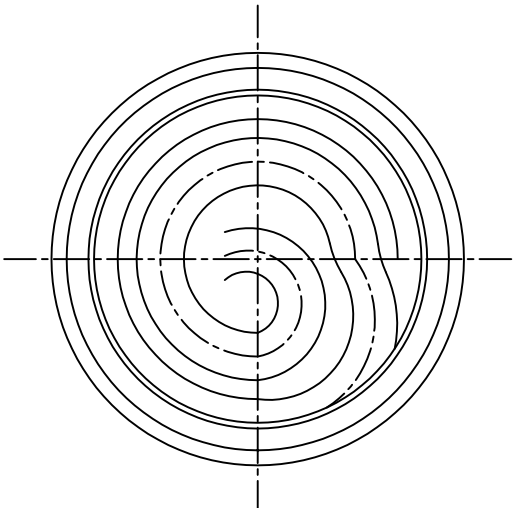

- Notes:
- Estimated AC operation in air:
 - 9.9V, 10.4A @ 800°C
 - 13.5V, 13.0A @ 1000°C
 - 16.5V, 15.2A @ 1100°C
 - 18.9V, 16.8A @ 1200°C
 - For use in 101446 assembly:
 - Heat Shield Pack - 103779
 - Spacers - 103780-01 & 103780-02
 - Filament is exposed out to $\phi 1.75$.

This document is the property of HeatWave Labs. Its contents may not be reproduced or distributed without express written permission of HeatWave Labs.

UNLESS OTHERWISE SPECIFIED
ALL DIMENSIONS ARE IN INCHES.
TOLERANCES ARE:
XXXX = ±.005 XX = ±.020
FINISH 63 MICRONDINGHES
ANGLES 0 DEGREE ±30 MINUTES
EDGES AND CORNERS .005 R MAX

MATERIAL

DD NOT SCALE DRAWING

1	103776	High Power $\phi 2.0$ UHV/ $\phi 2$ Heater	1
Qty.	Part #	Description	Item #
<p>HeatWave Labs, Inc. 195 Aviation Way, Suite 100 (831) 722-9081 Watsonville, Ca. 95076 Fax: (831) 722-5491 Website: www.heatwave.com</p>			
DRAWN BY		DATE	
ENGR	M.Curtis	9/7/06	
SIZE	Cage Code	DWG. NO.	REV
A	1YAN4	103747	B1
High Power $\phi 2.0$ UHV/ $\phi 2$ Heater			
SCALE: 1x			SHEET: 1/1