

Dash #	Next Assembly
-	-

REVISIONS			
REV	DESCRIPTION	DATE	APPROVED

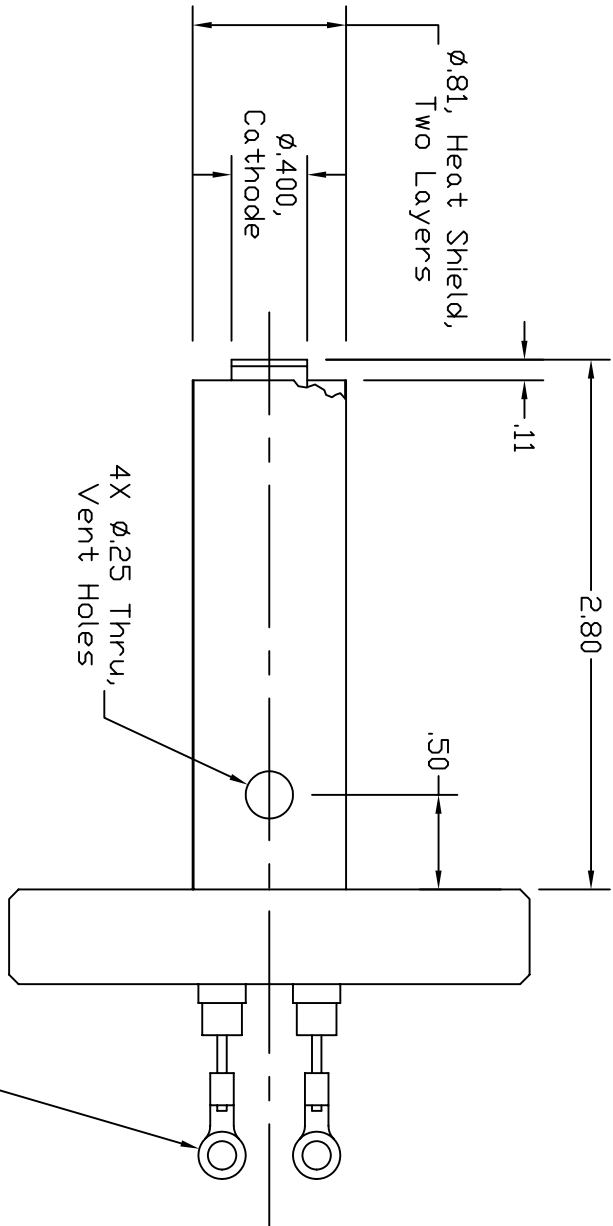
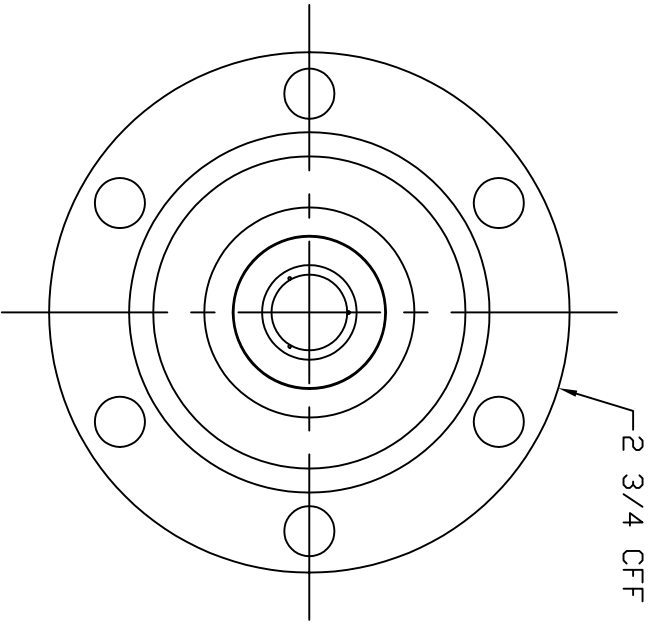

- Notes:
- Estimated operation:
 5,60V, 3.39A @ 1000°C
 7,20V, 3.75A @ 1100°C
 Temperature curve to be developed after assembly.

This document is the property of HeatWave Labs. Its contents may not be reproduced or distributed without express written permission of HeatWave Labs.

UNLESS OTHERWISE SPECIFIED
 ALL DIMENSIONS ARE IN INCHES.
 TOLERANCES ARE:
 .XXX = ±.005 .XX = ±.020
 .XXXX = ±.0005
 FINISH 63 MICROINCHES
 ANGLES 0 DEGREE ±30 MINUTES
 EDGES AND CORNERS .005 R MAX

MATERIAL
 -

DO NOT SCALE DRAWING

1	103375	2 3/4 CFF Mounted	101109-04	-
Qty.	Part #	Description	Item #	

HeatWave Labs, Inc.
 195 Aviation Way, Suite 100 (831) 722-9081
 Watsonville, Ca. 95076 Fax: (831) 722-5491
 Website: www.cathode.com

BY: M.Curtis DATE: 11/10/05

2 3/4 CFF Mounted
 101109-04 Cathode

SIZE: A Code Code: 1VAN4 DWG. NO.: 103371 REV: -

THIRD ANGLE PROJECTION SCALE: 1x SHEET: 1/1