

REVISIONS			
REV	DESCRIPTION	DATE	APPROVED
A	.575 was .559.	9/18/01	MC

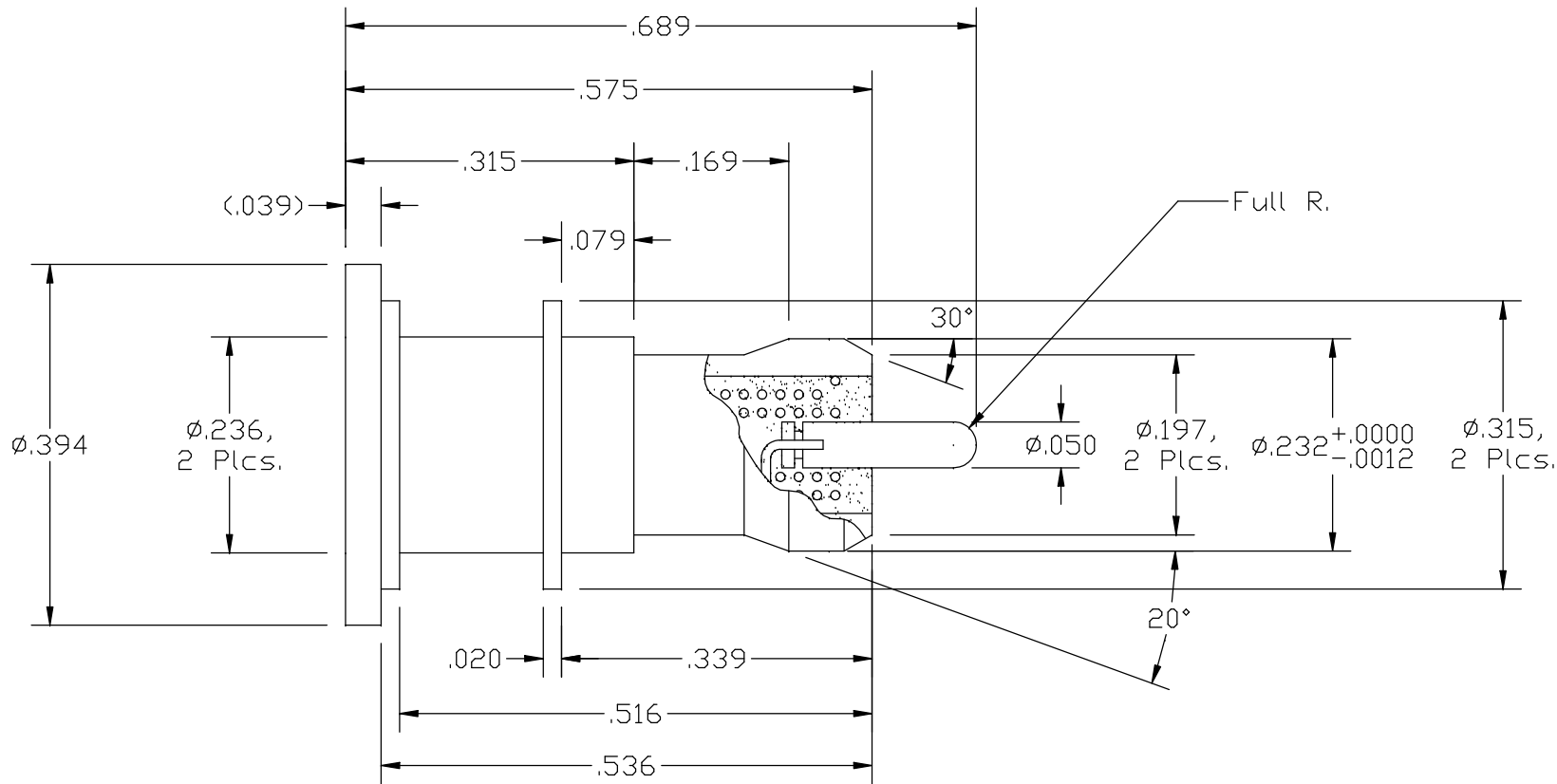

Notes:

1. Filament to pin connection and ground lead configuration subject to vendor suggestion and HeatWave Labs approval.
2. Heater target:  
1A @ 375°C  
2A @ 1000°C
3. Hole or groove in pin may be allowed to facilitate potting.

This document is the property of HeatWave Labs, Inc. Its contents may not be reproduced or distributed without express written permission of HeatWave Labs, Inc.

UNLESS OTHERWISE SPECIFIED  
ALL DIMENSIONS ARE IN INCHES.  
TOLERANCES ARE:  
.XXX = ±.005 .XX = ±.020  
.XXXX = ±.0005  
FINISH 63 MICROINCHES  
ANGLES 0 DEGREE ±30 MINUTES  
EDGES AND CORNERS .005 R MAX

**HeatWave Labs, Inc.**

195 Aviation Way, Suite 100 (831) 722-9081  
Watsonville, Ca. 95076 Fax: (831) 722-5491  
Website: www.cathode.com

MATERIAL  
Moly  
DO NOT SCALE DRAWING

BY	DATE
DRAWN	
ENGR	M.Curtis 1/12/00
Sim to 1464	

Stub Heater			
SIZE A	FSCN NO.	DWG. NO. 101483	REV A
THIRD ANGLE PROJECTION		SCALE: 5x	SHEET: 1/1