

Dash # Next Assembly

Table A

Dash #	"A"
-01	1.969
-02	1.378

REVISIONS		DATE	APPROVED
REV	DESCRIPTION		
H	.120 holes where .118, .010 TIR was .020.	1/9/03	MC

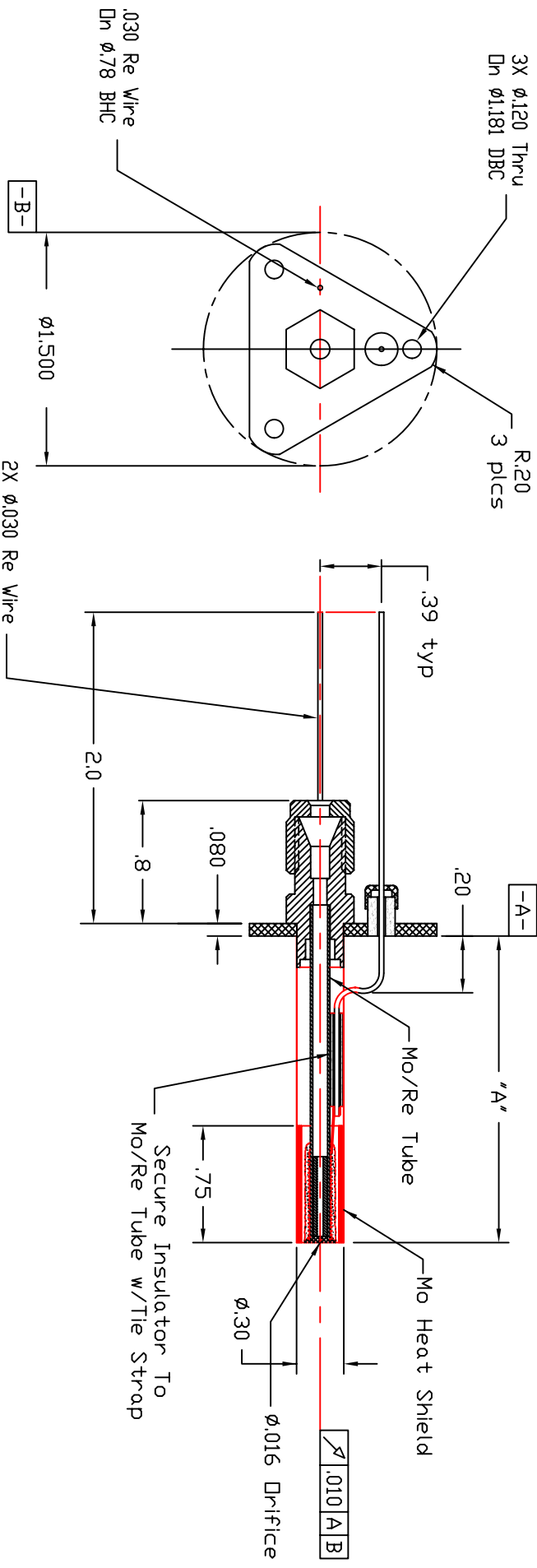

Qty.	Part #	Description	Item #
1	102048	35mm Long Hollow Cathode	-
-	102047	50mm Long Hollow Cathode	-

UNLESS OTHERWISE SPECIFIED
ALL DIMENSIONS ARE IN INCHES.
TOLERANCES ARE:
.XXX = ±.005 .XX = ±.020
XXXX = ±.005
FINISH G3 MICROINCHES
ANGLES 0 DEGREE ±30 MINUTES
EDGES AND CORNERS .005 R MAX

195 Aviation Way, Suite 100 (831) 722-9081
Watsonville, Ca. 95076 Fax: (831) 722-5491
Website: www.cathode.com

MATERIAL

BY DATE
DRAWN ENGR M.Curtis 1/2/03

Indirectly Heated Hollow Cathode

This document is the property of HeatWave Labs. Its contents may not be reproduced or distributed without express written permission of HeatWave Labs.

DD NOT SCALE DRAWING

SIZE Cage Code DWG. NO. REV
A 1YAN4 101053 H
THIRD ANGLE PROJECTION SCALE: 1x SHEET: 1/1